

VΨDORA^

A safe and secluded spot, *immersed in nature* where you behold the blazing sunset through jungle leaves over the crystal clear Pacific Ocean.

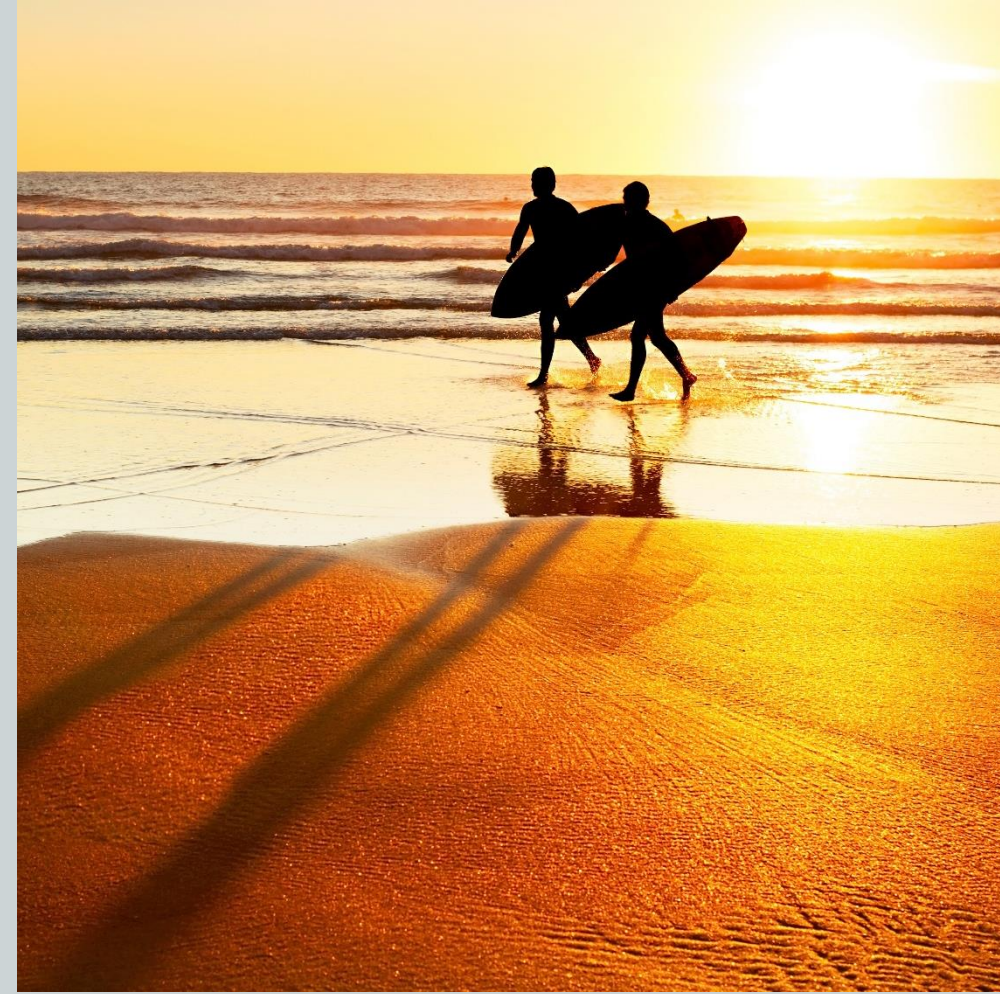



VΨDORA

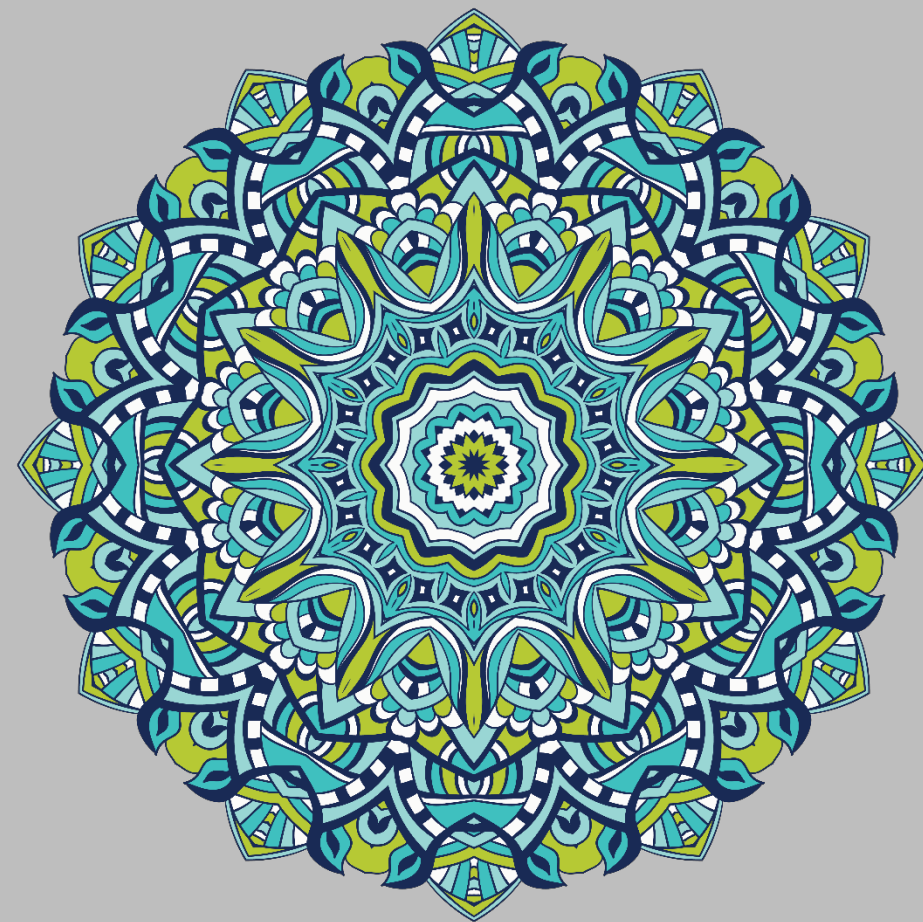

1

Inspiration

Comfortable and stylish; a modern,
uncomplicated and elegant hotel with the laid-
back soul of a bohemian in the natural hub of
Manuel Antonio

Vana Belle Ko Samui

The style is simple and unpretentious, giving the hotel a peaceful atmosphere ideal for relaxation. The rooms are private and spacious, with large, open bathrooms and some with split levels. The textures and finishes are natural and the color scheme strictly neutral in creams and browns.

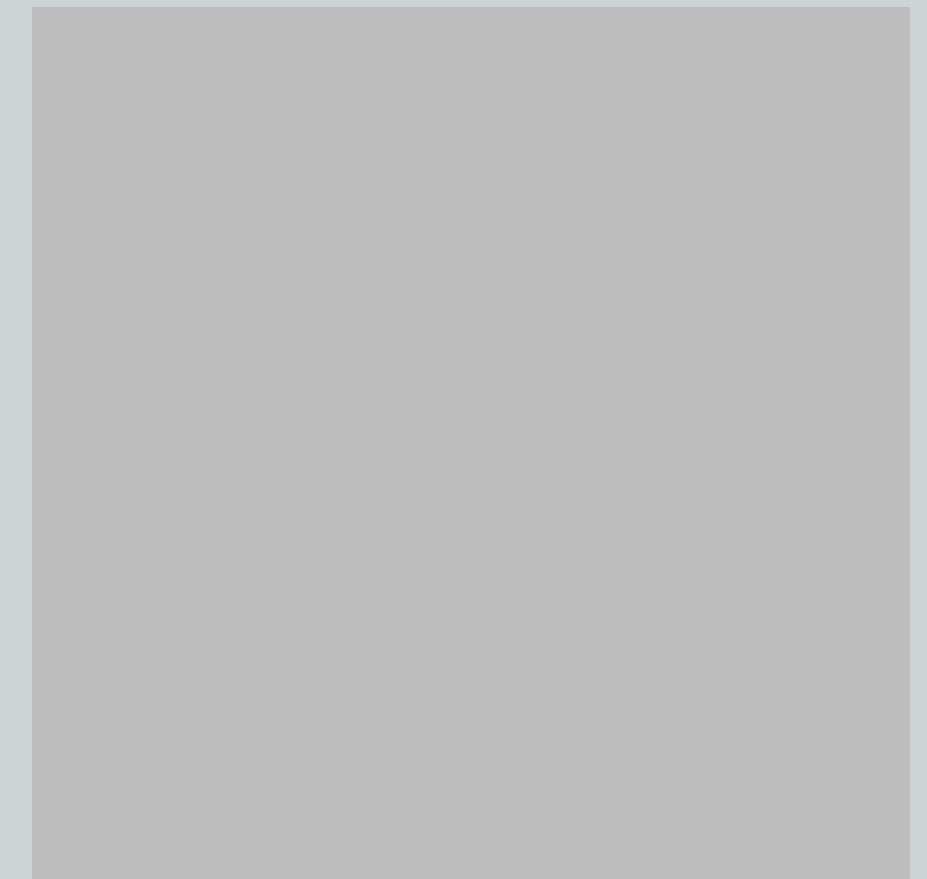
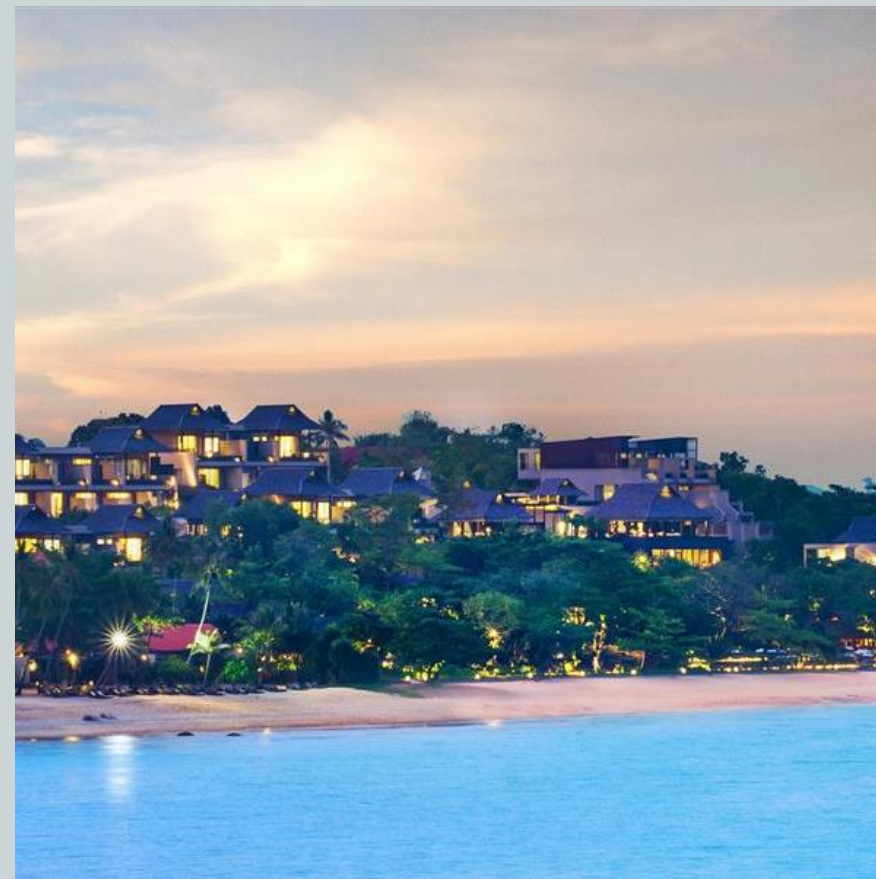
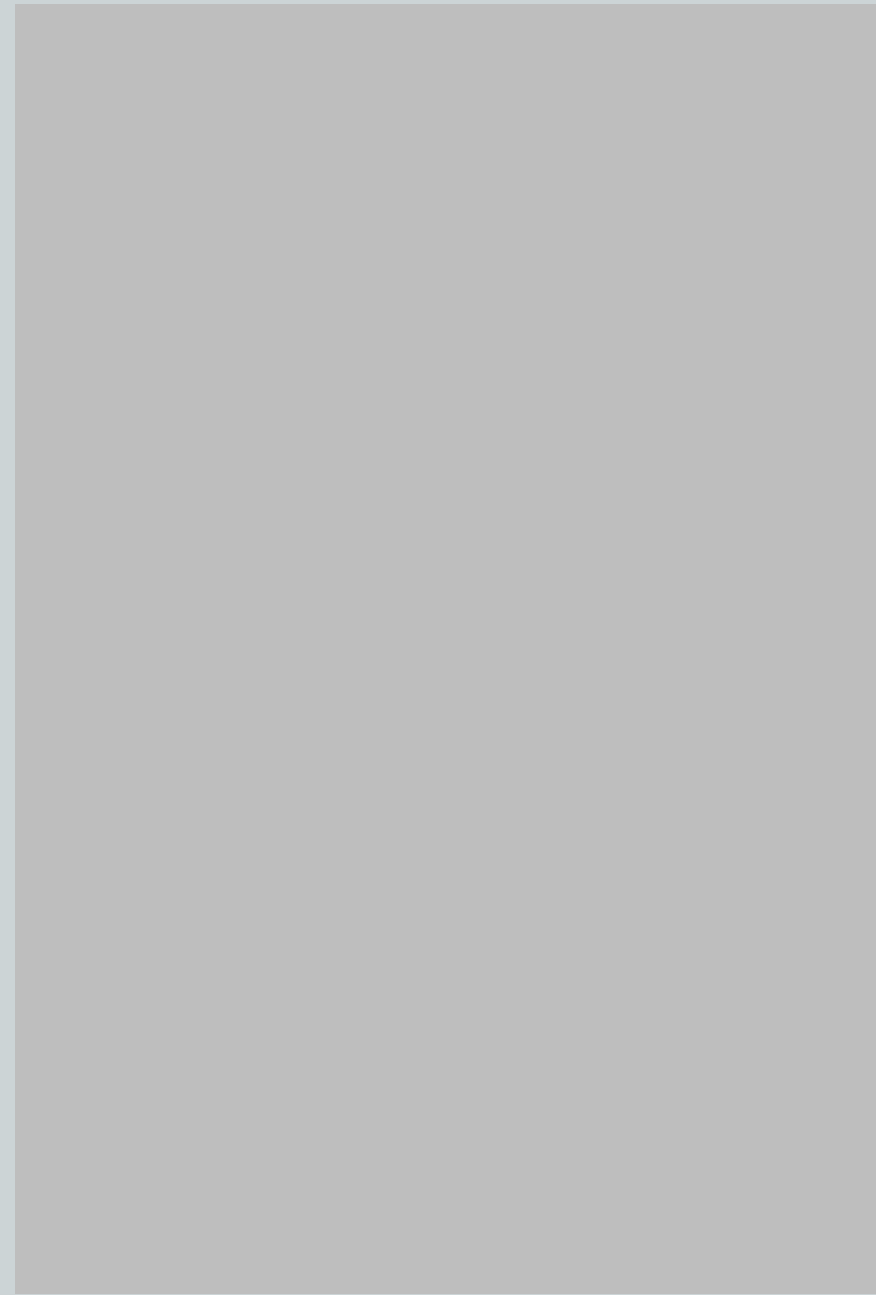



Comfortable and low-key.
Designed to blend in, the
craftmanship stands out.
Your room is your place to
center yourself, open out to
the sounds of nature or
settle in to listen to your
inner voice.

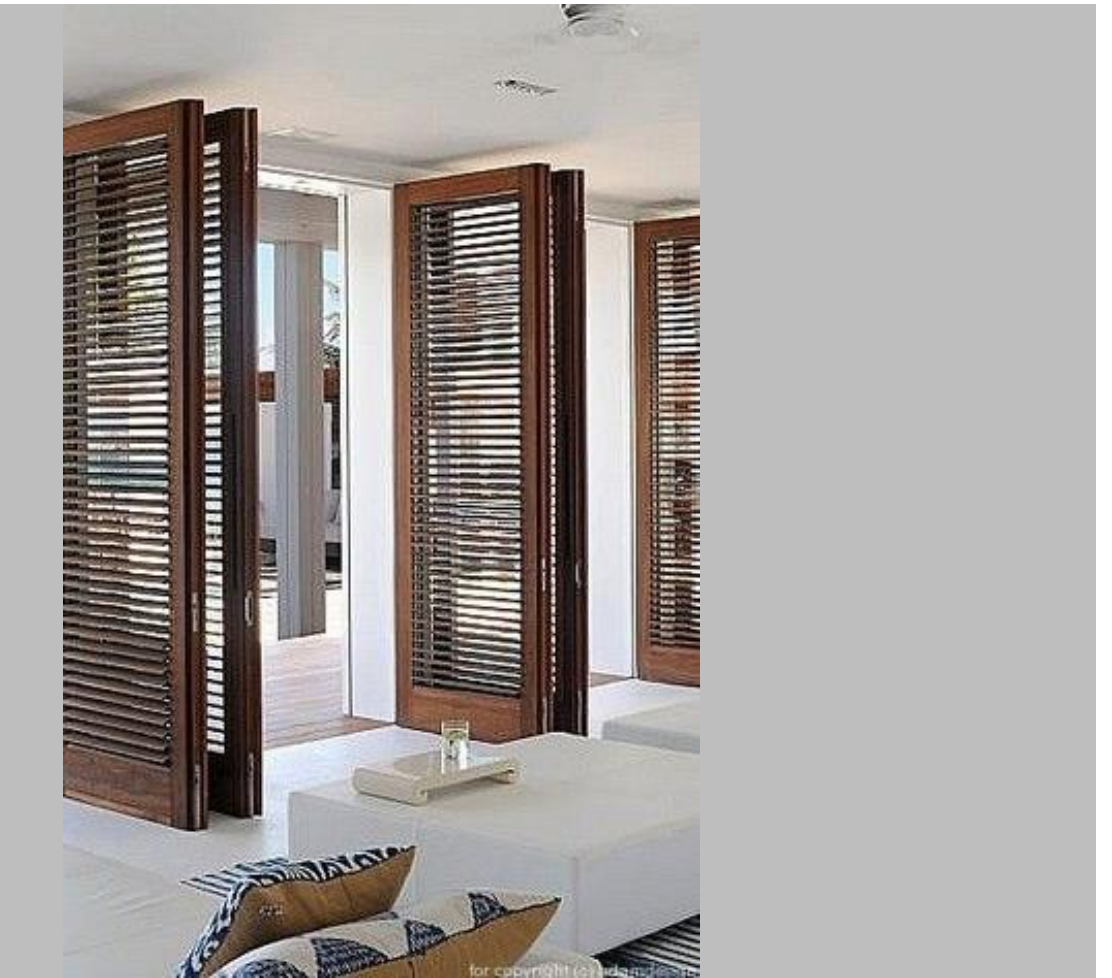

VΨDΩRΛ



2

Guestrooms

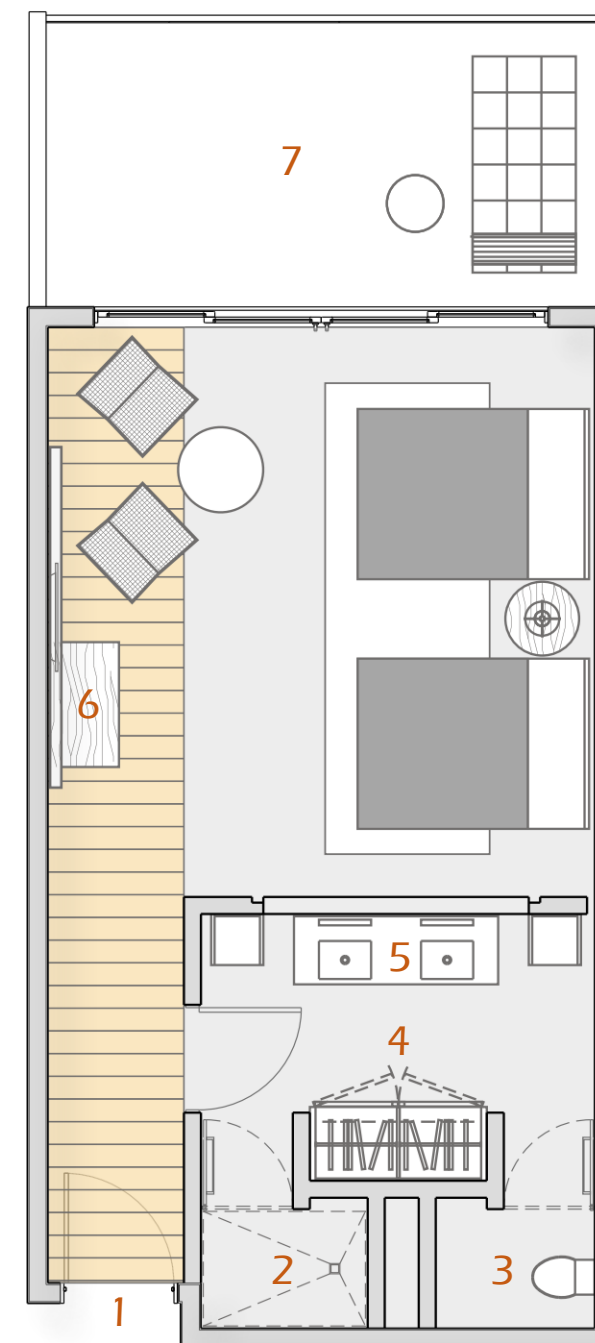
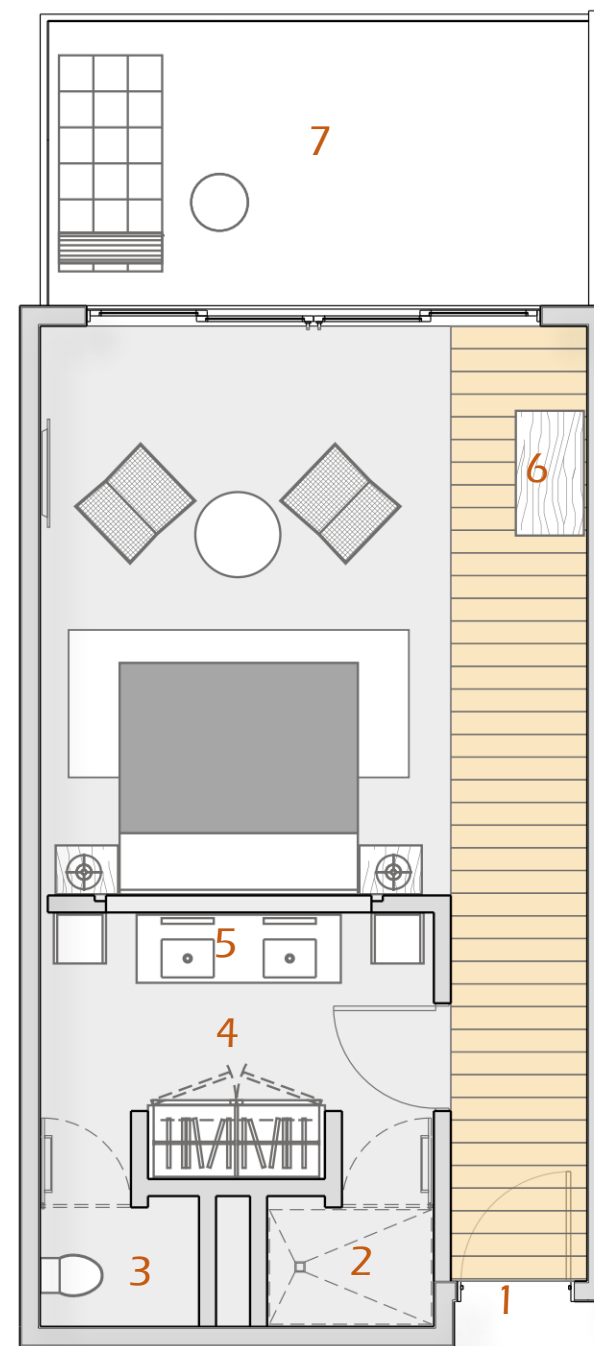

Typical Guestrooms

1. Entry
2. Shower
3. WC Cabin
4. Wardrobe
5. Bathroom
6. Minibar
7. Terrace

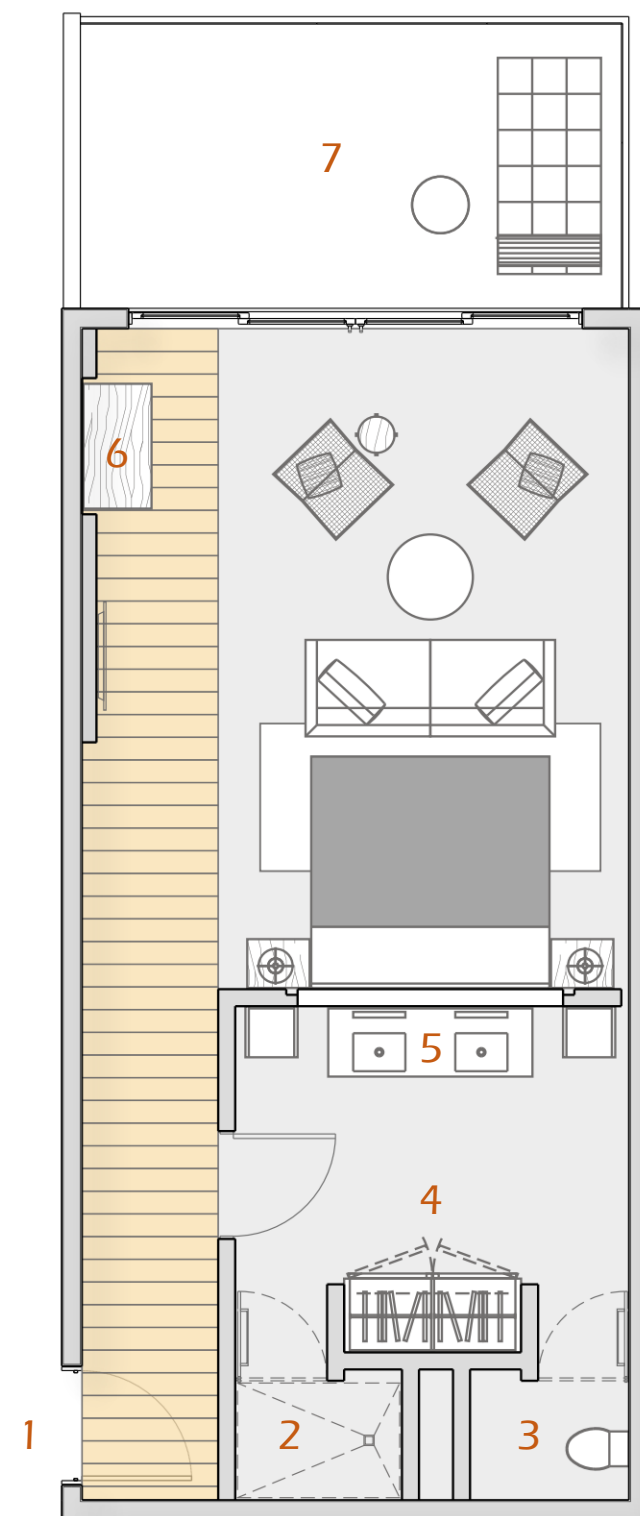

Corner Guestrooms

1. Entry
2. Shower
3. WC Cabin
4. Wardrobe
5. Bathroom
6. Minibar
7. Terrace

Material & Color Palette



Limestone



Wood (Millwork/Doors)



Stacked Stone



Wood Floor



Metal



Mosaic Tile



Accent Surfaces

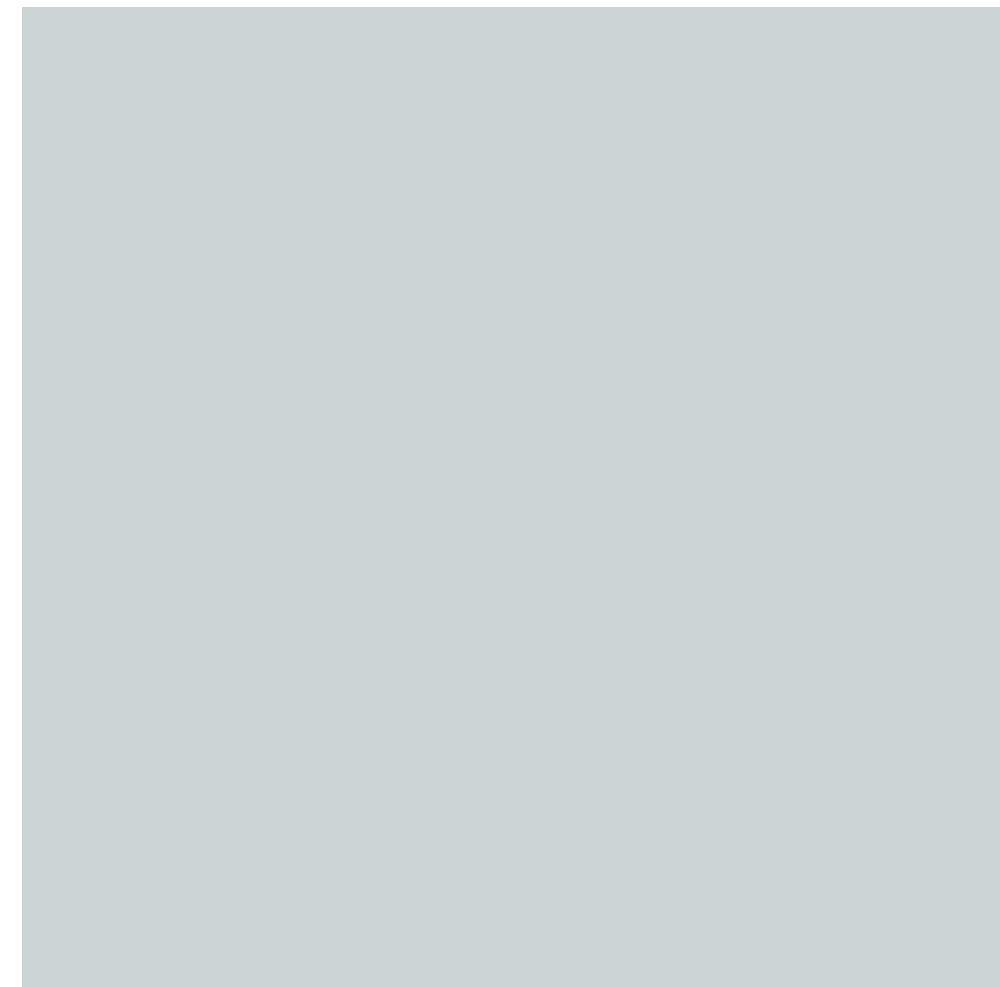
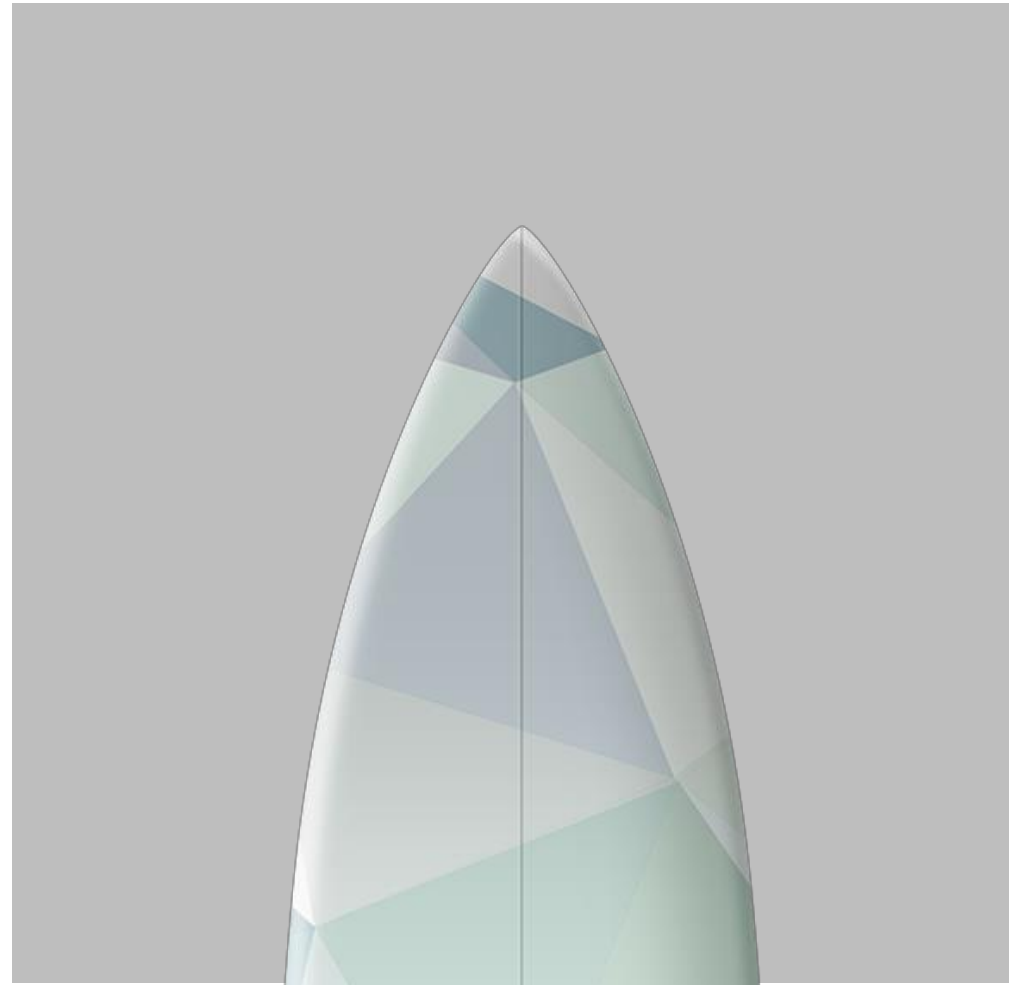

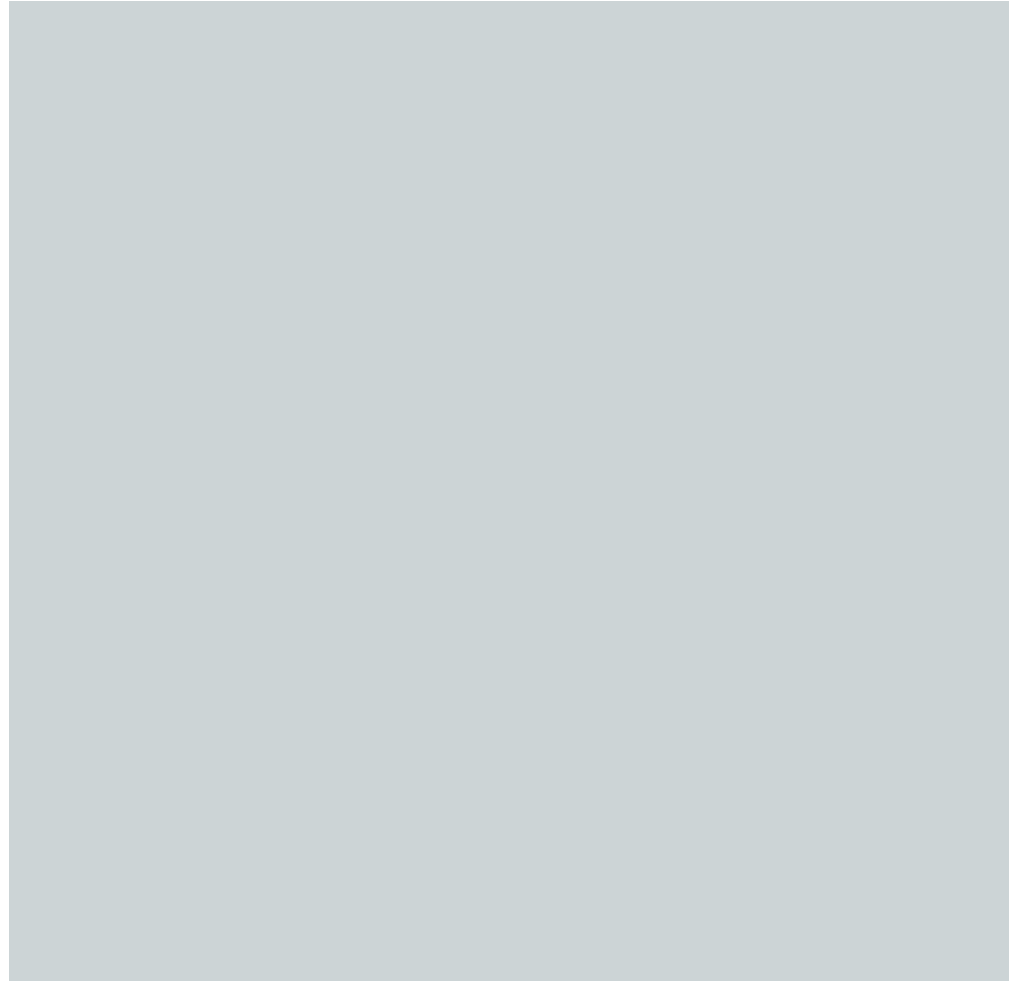

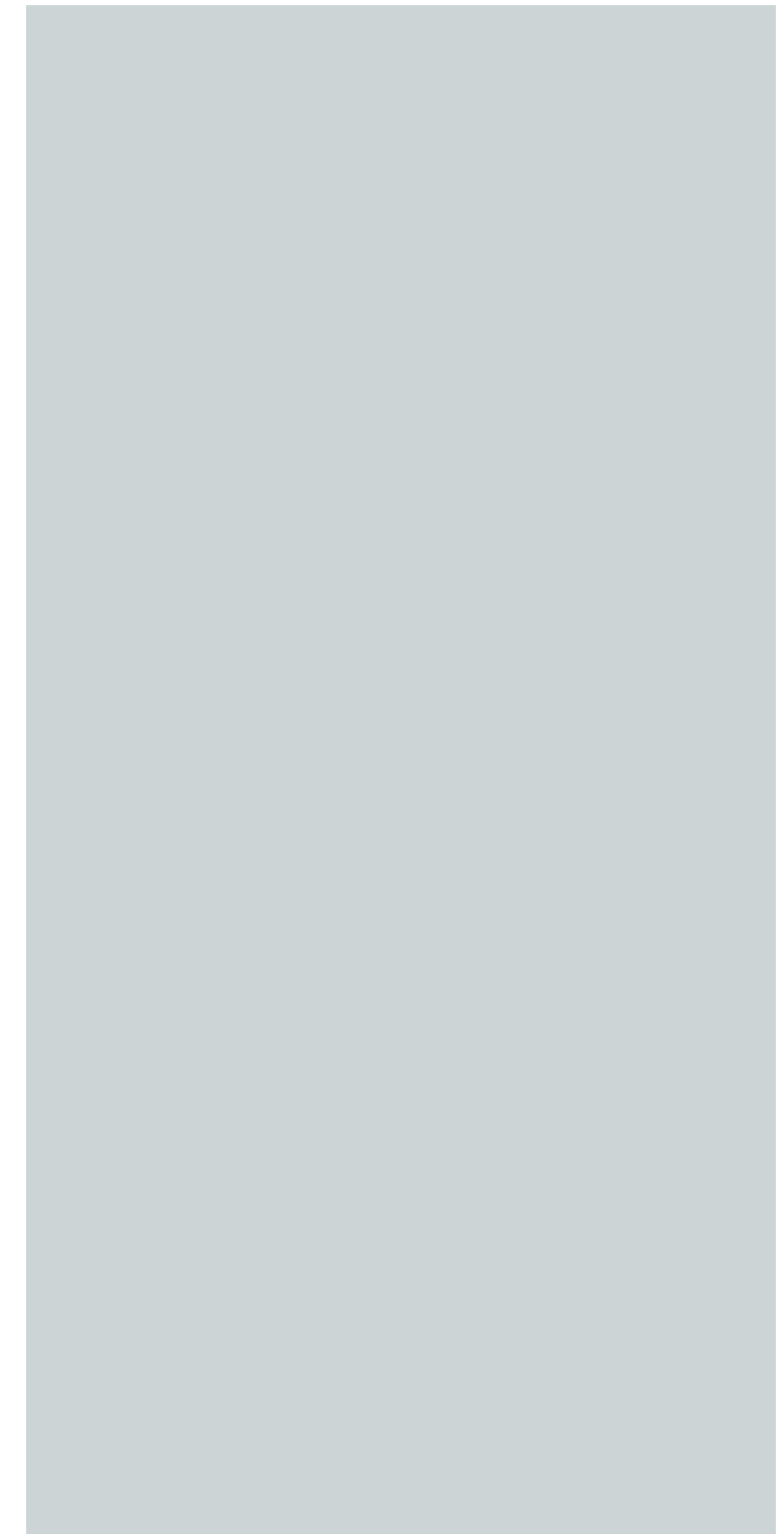

VVDORA



3
Suites

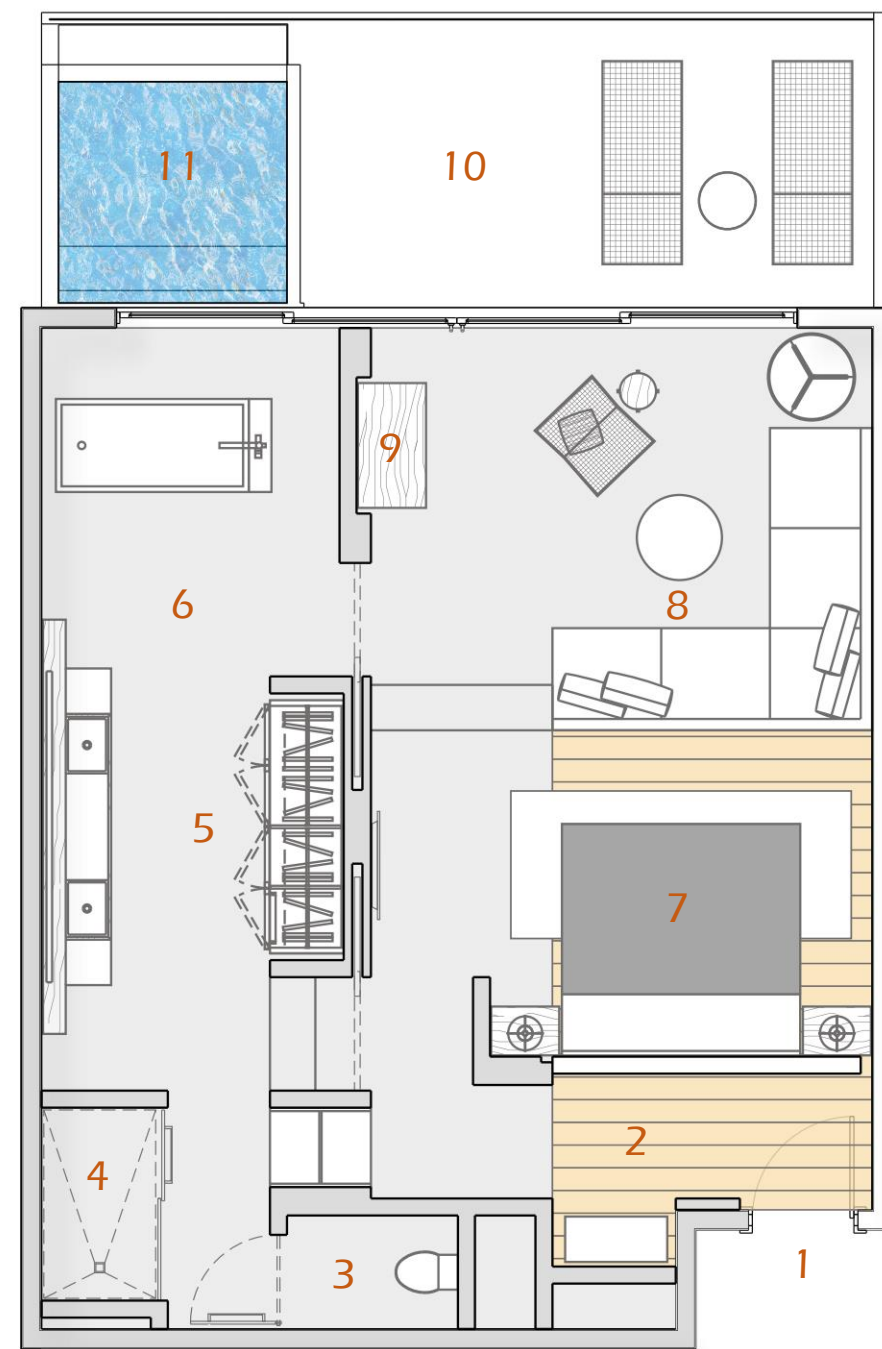

Typical Suite

1. Entry
2. Foyer
3. WC Cabin
4. Shower
5. Wardrobe
6. Bathroom
7. Bedroom
8. Living Space
9. Minibar
10. Terrace
11. Plunge Pool

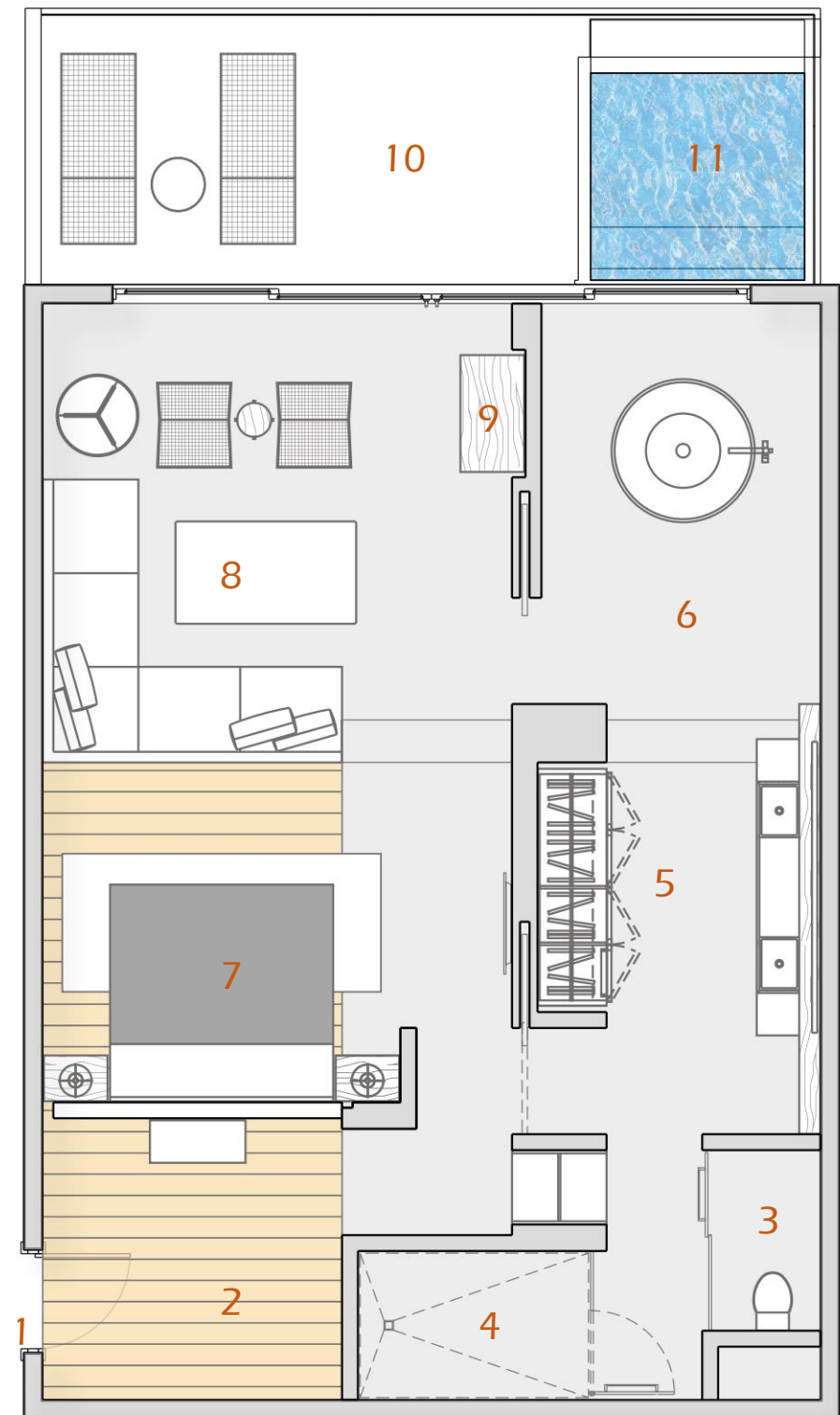

Corner Suite

- 1. Entry
- 2. Foyer
- 3. WC Cabin
- 4. Shower
- 5. Wardrobe
- 6. Bathroom
- 7. Bedroom
- 8. Living Space
- 9. Minibar
- 10. Terrace
- 11. Plunge Pool



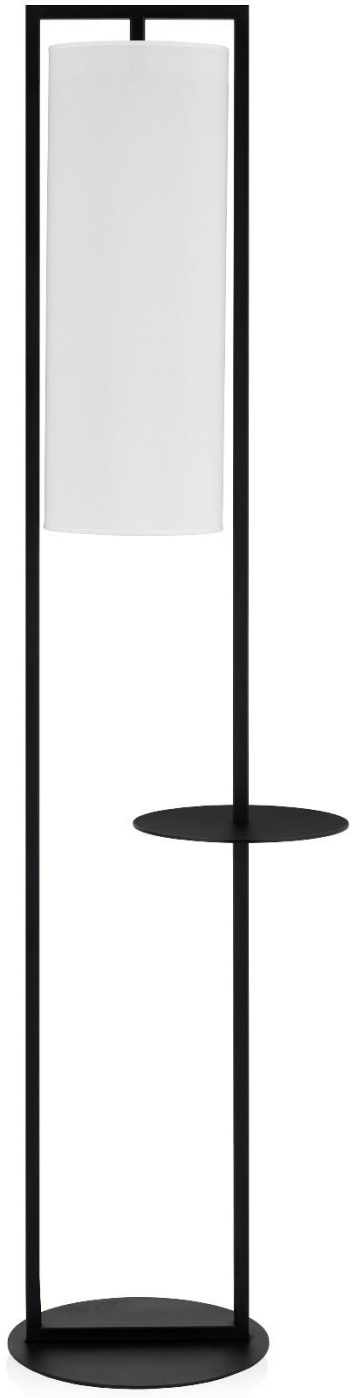
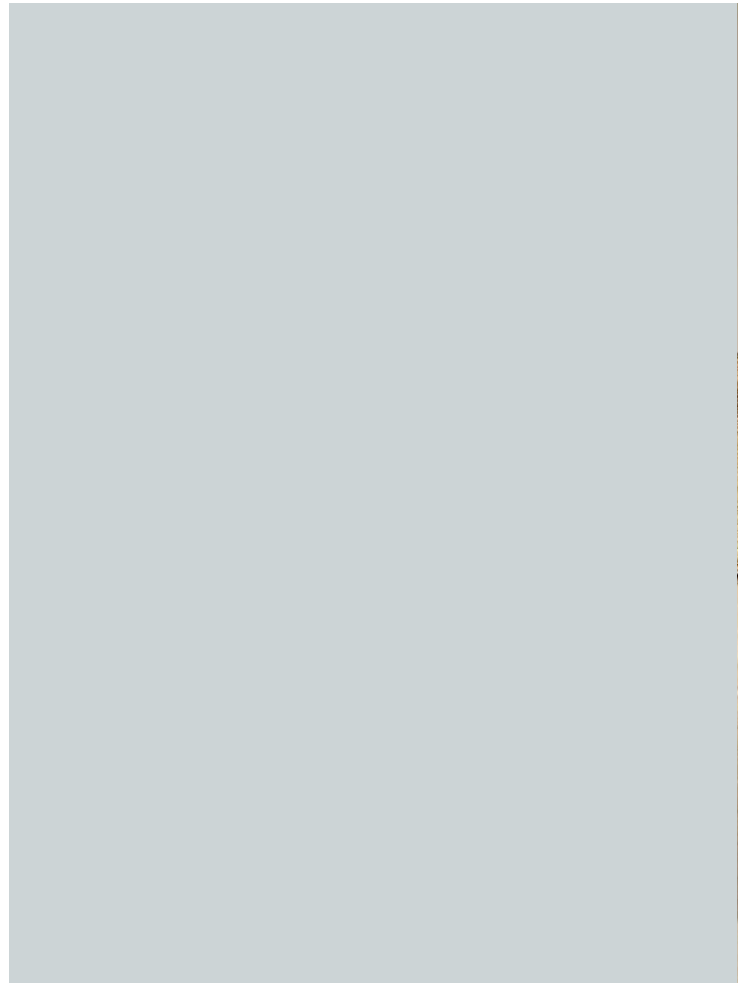
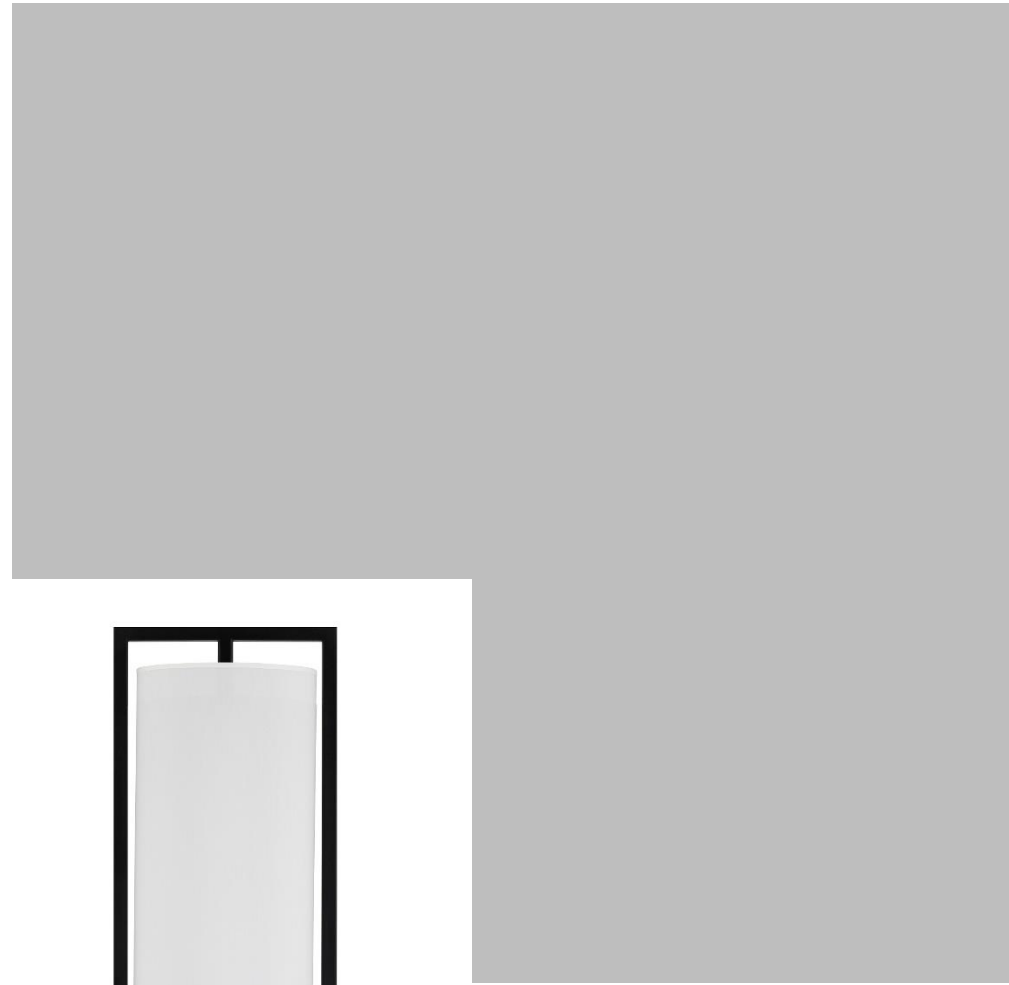





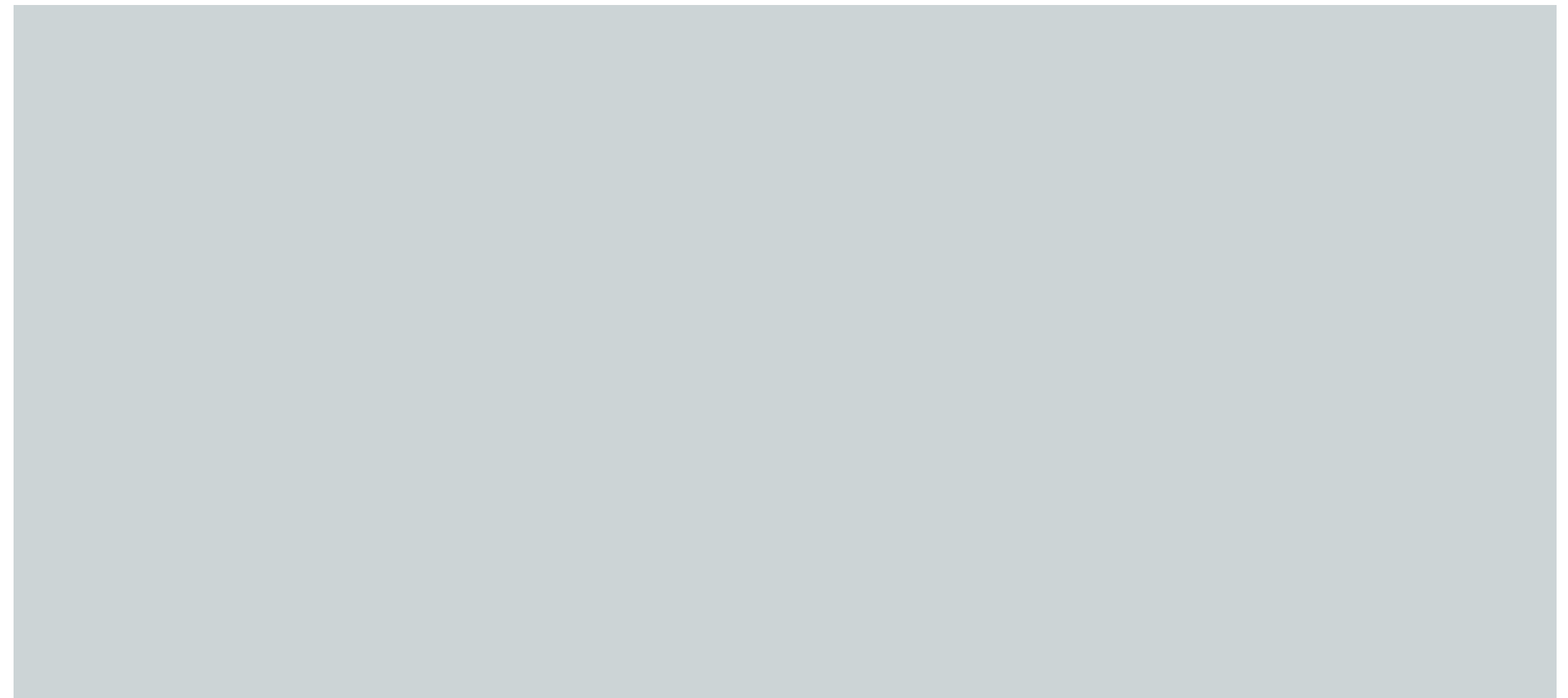
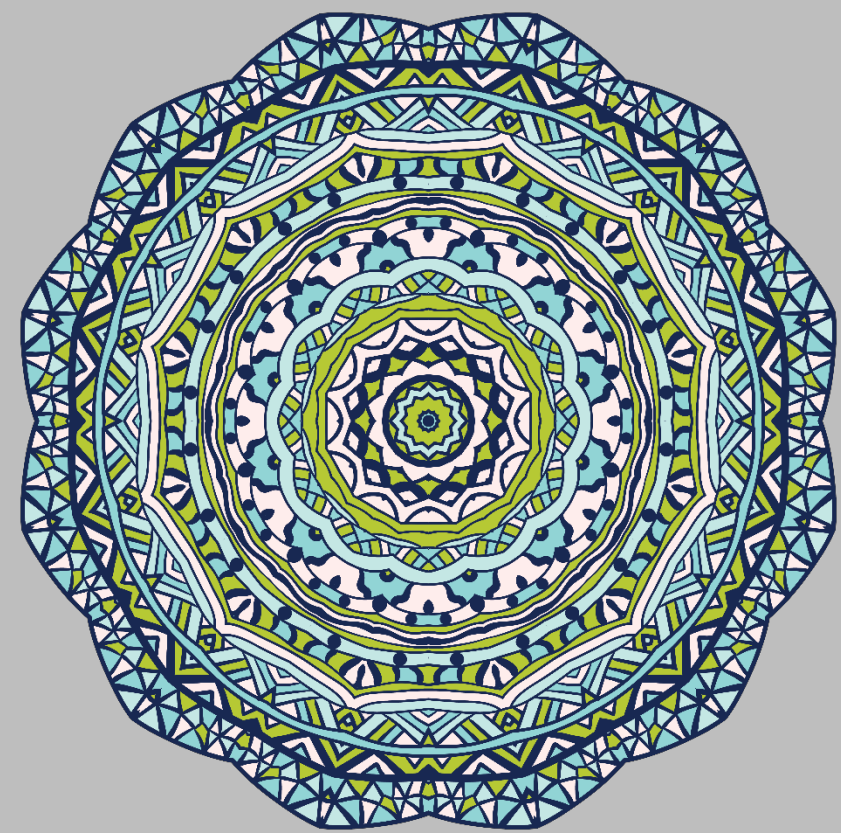







An Experience Delivered